

KEY

Cair Roll
Pre-established 300mm diameter rolls manufactured by Salix or similar and approved. Standard Mix -
Carex acutiformis 20%
Juncus effusus 20%
Lythrum salicaria 20%
Iris pseudacorus 20%
Phalaris arundinacea 20%

Lower Marginal/Aquatic Mix B - 1L @ 8/m²
Butomus umbellatus 12%
Carex riparia 16%
Eleocharis palustris 12%
Iris pseudacorus 16%
Glyceria maxima 12%
Juncus articulatus 16%
Phragmites australis 16%

Upper Marginal Mix A - 1L @ 8/m²
Angelica sylvestris 10%
Cardamine pratensis 10%
Carex pendula 10%
Filipendula ulmaria 10%
Epilobium hirsutum 10%
Glyceria declinata 10%
Juncus articulatus 10%
Lychnis flos cuculi 10%
Lythrum salicaria 10%
Veronica catenata 10%

Terrestrial Mix C
1L@8/m² in groups of 15 by species
Bidens cernua 10%
Cardamine pratensis 10%
Deschampsia cespitosa 10%
Dipsacus fullonum 10%
Filipendula ulmaria 10%
Juncus effusus 05%
Juncus inflexus 05%
Lotus pendunculatus 10%
Lychnis flos cuculi 10%
Lysimachia vulgaris 10%
Scirpus sylvaticus 10%

Path Mix - 1L @ 8/m²
Arrhenatherum elatius 10%
Cardamine pratensis 10%
Carex pendula 20%
Deschampsia cespitosa 20%
Lychnis flos-cuculi 10%
Dipsacus fullonum 10%
Scirpus sylvaticus 20%

Proposed Trees/Shrubs

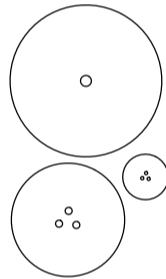

General Purpose Meadow Mix
Emorsgate Wildflower Meadow Mix EM2 sown at a rate of 4g/m² or similar and approved.

Wildflowers

Achillea millefolium	0.5
Centaurea nigra	2
Daucus carota	0.5
Galium verum	1.5
Knautia arvensis	2
Leucanthemum vulgare	2
Lotus corniculatus	2
Plantago lanceolata	2
Primula veris	1.5
Frunella vulgaris	0.4
Ranunculus acris	3
Rhinanthus minor	1.5
Rumex acetosa	1
Trifolium pratense	0.1
	20%

Grasses

Agrostis capillaris	8
Cynosurus cristatus	40
Festuca rubra	28
Phleum bertolonii	4
Alopecurus pratensis	5
Anthoxanthum odoratum	1
Briza media	1
Cynosurus cristatus	36
Deschampsia cespitosa	1
Festuca rubra	24
	80%

Basic Wildflower Meadow Mix
Emorsgate Wildflower Meadow Mix EM1 sown at a rate of 4g/m² or similar and approved.

Wildflowers

Achillea millefolium	0.5
Centaurea nigra	2
Galium verum	1
Leucanthemum vulgare	2
Lotus corniculatus	2
Plantago lanceolata	2
Poterium sanguisorba - (Sanguisorba minor)	3
Ranunculus acris	3
Rumex acetosa	0.4
Silene dioica	2
Silene vulgaris	2
Trifolium pratense	0.1
	20%

Grasses

Agrostis capillaris	8
Cynosurus cristatus	40
Festuca rubra	28
Phleum bertolonii	4
	80%

Amenity Grass Mix
British Seed Houses 'A19' grass seed mix, sown at a rate of 25g/m² or similar and approved.

Live Willow Stakes
Stakes @2m² manufactured by Salix or similar and approved.

Salix caprea	50%
Salix cinerea	50%

Live Willow Plantations

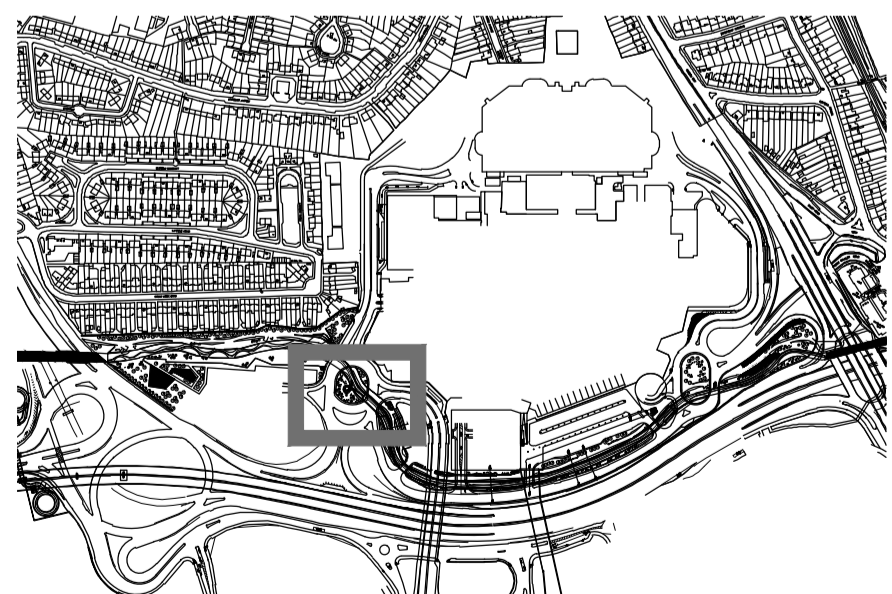

Extent of Brent River Park Phase 1AN

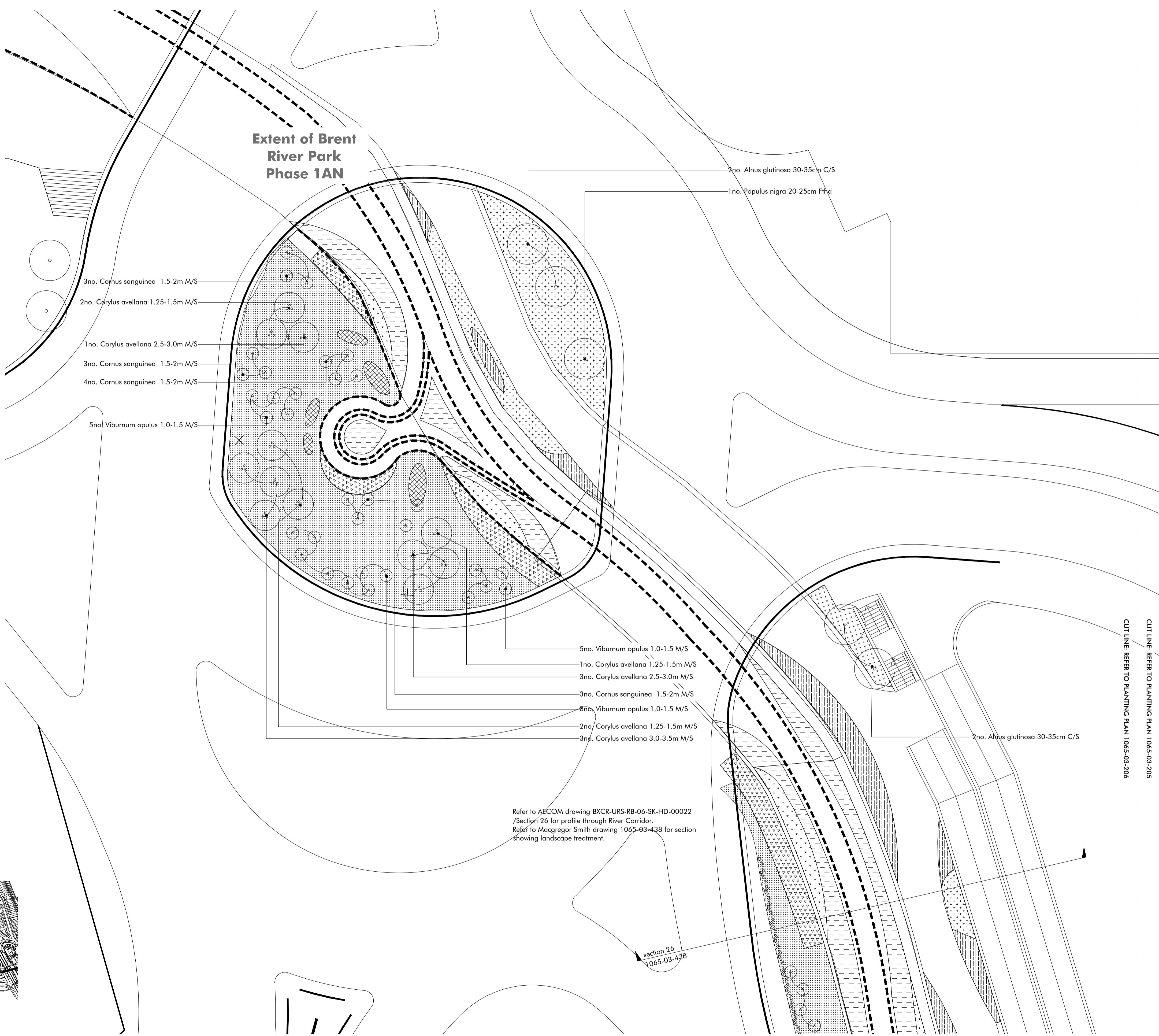

Refer to AECOM drawing BXCR-URS-RB-06-SK-HD-00022 /Section 26 for profile through River Corridor.
Refer to Macgregor Smith drawing 1065-03-438 for section showing landscape treatment.

section 26
1065-03-438

CUT LINE - REFER TO PLANTING PLAN 1065-03-206
CUT LINE - REFER TO PLANTING PLAN 1065-03-205

Revision	Description	Drawn by	Checked by	Date
-	1st issue	JR	IG	07.11.14
A	Phase 1AN RMA Submission	JR	IG	14.11.14
B	Phase 1AN RMA Submission	RH	JR	28.11.14
C	Updated River Corridor	JR	GJ	18.05.15
D	Phase 1AN RMA Submission	JR	GJ	26.05.15

NOTE

A To be read in conjunction with Macgregor Smith Base, Soft and Hardworks Specifications
B For sections refer to drawings 1065-03-433 to 1065-03-438

Xrefs

ARCH - CT - SK-937-rev_01_Masterplan 3C Outline
ENG - AECOM - BXCR-URS-RB-06-M2-HD-00001
ENG - AECOM - BXCR-URS-RB-06-M2-HD-00002
ENG - AECOM - BXCR-URS-RB-06-M2-HD-00003
ENG - AECOM - BXCR-URS-ZZ-HW-M2-CE-00002_P24
ENG - AECOM - BXCR-URS-ZZ-HW-M2-CE-00004

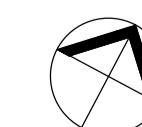
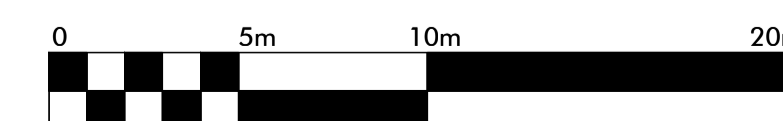

Macgregor • Smith
Landscape Architecture

project	Brent Cross Cricklewood	drawn by	JR
status	Phase 1AN RMA Submission	checked by	IG
title	Brent River Park Reach 2 Planting Plan - 06/09	date	29.10.14
		scale	1/200@A1
drawing No	1065-03-206	revision	D