

Plot Date: 12-May-09 09:53 AM BY: 31124ah  
 AutoCAD File Name: [7] K:\D11870 - BXC\06 Design\CAD\Sheets\Infrastructure Planning Application April 09\IP\_D111870\_H\_100\_1023-C.dwg [9 Xrefs] X-New-Rail-Design-070119.DWG X-OS-Base-880728.DWG X-Res-Line-Boundary-081021.DWG X-New-Highway-Design-080428.DWG

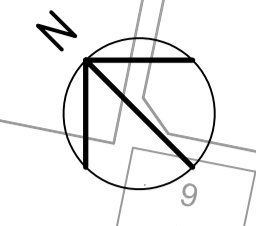

**NOTES**  
 1. FOR LOCATION REFER TO KEY PLAN DRAWING P/D111870/H/100/1000

**KEY**  
— PLANNING APPLICATION BOUNDARY

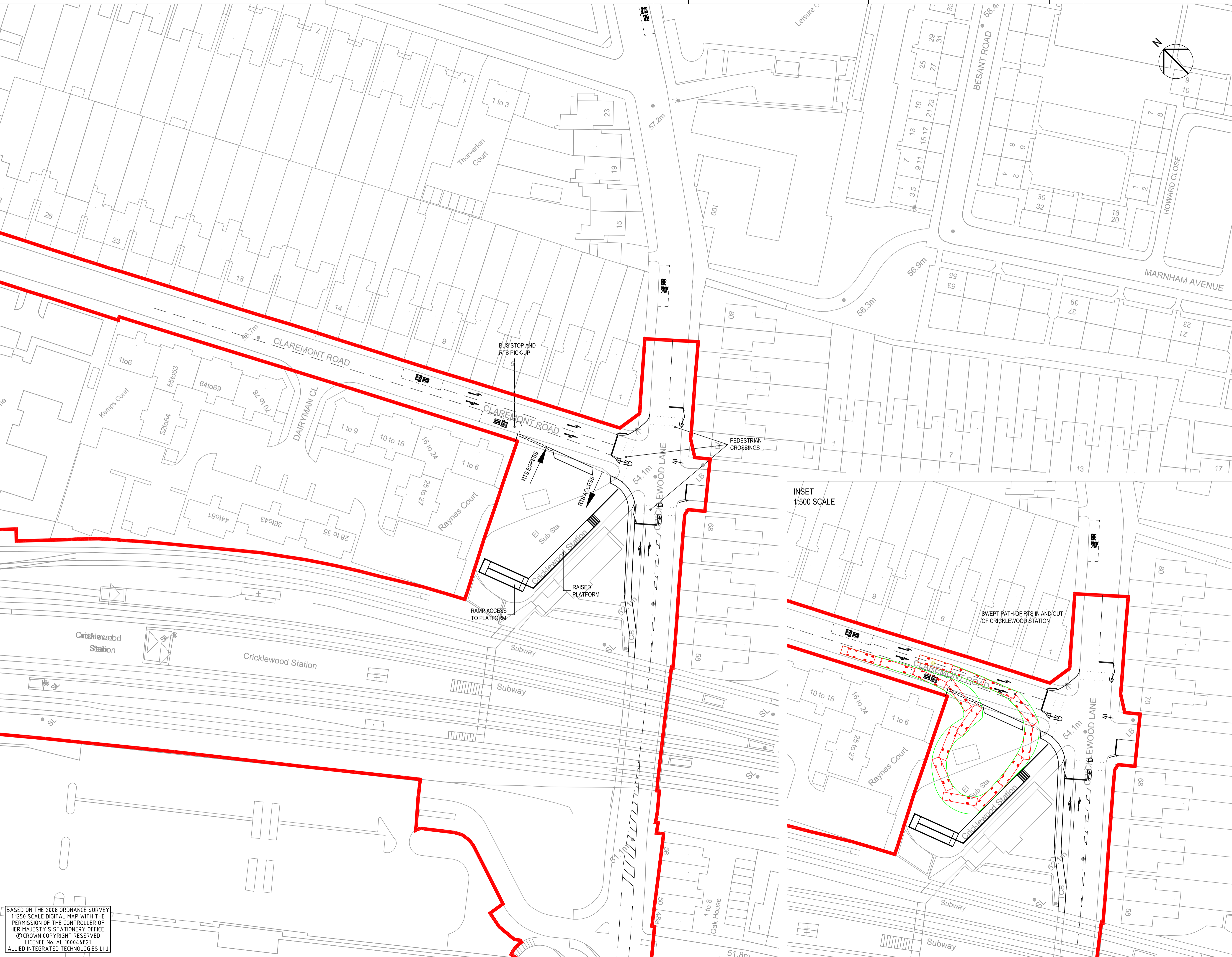
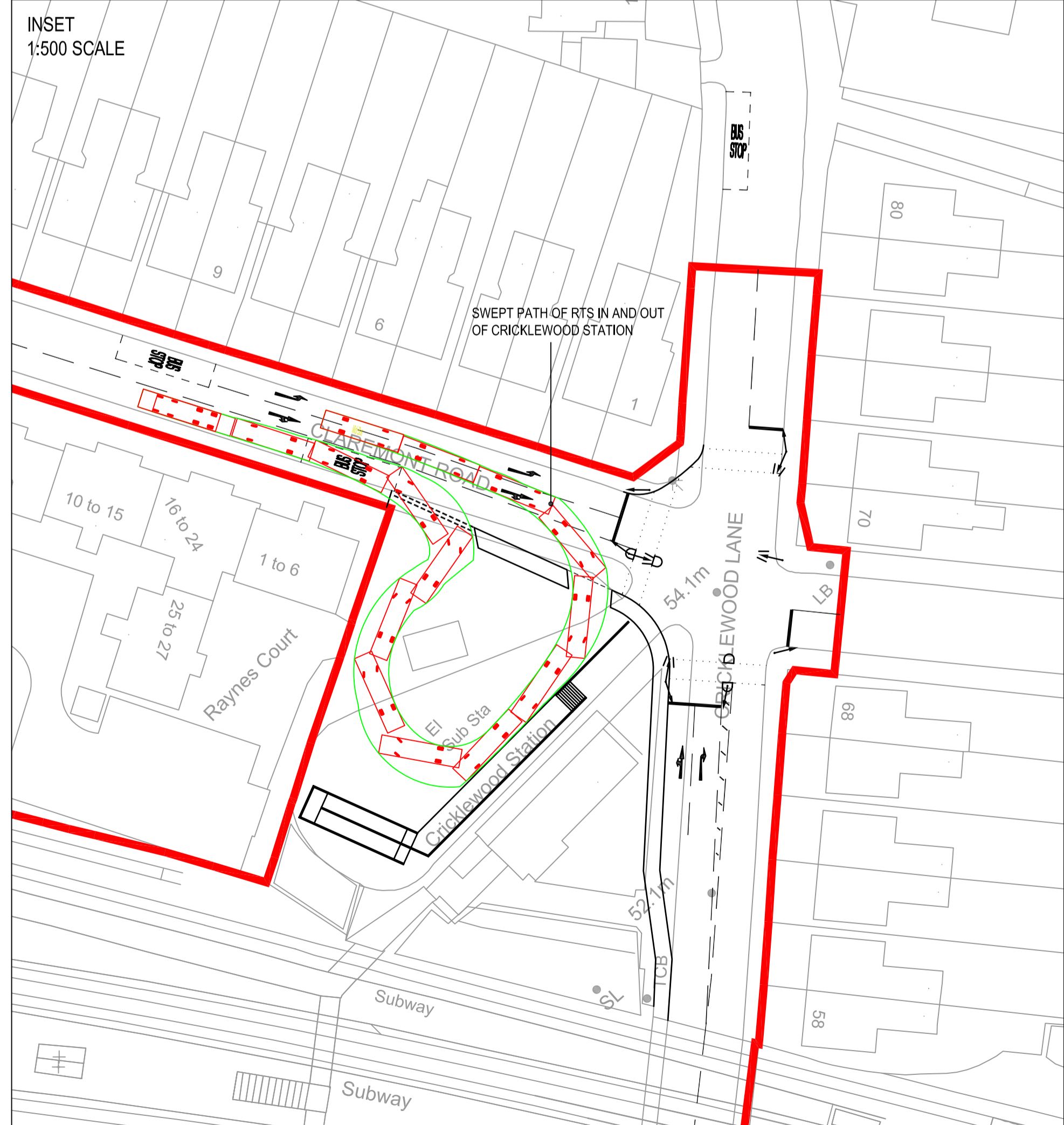

BASED ON THE 2008 ORDNANCE SURVEY  
 1:250 SCALE DIGITAL MAP WITH THE  
 PERMISSION OF THE CONTROLLER OF  
 HER MAJESTY'S STATIONERY OFFICE.  
 © CROWN COPYRIGHT RESERVED  
 LICENCE No. AL 100044821  
 ALLIED INTEGRATED TECHNOLOGIES Ltd

Revision Details	By	Date	Suffix
RTS FACILITY REVISED	AH AJA	30.04.09	C
OS MAPPING AND HIGHWAY LAYOUT REVISED	AH AJA	26.08.08	B
PLANNING APPLICATION BOUNDARY AND HIGHWAY LAYOUT REVISED	AH AJA	29.02.08	A

Drawing Status  
**OUTLINE PLANNING**

Job Title  
**BRENT CROSS/  
 CRICKLEWOOD  
 REGENERATION**

Drawing Title  
**PROPOSED HIGHWAY  
 LAYOUT**

**SHEET 23 OF 31**

Scale at A1 1:500	Drawn AH	Approved
Stage 1 check SES	Stage 2 check Originated	Date 19.01.07

This document has been prepared in accordance with the scope of Scott Wilson's appointment with its client and is subject to the terms of that appointment. Scott Wilson accepts no liability for any use of this document other than by its client and only for the purposes for which it was prepared and provided.  
 © Scott Wilson Ltd 2008

**Scott Wilson**  
 Scott House  
 Altonon Link, Basingstoke  
 Hampshire, RG21 7PP  
 Telephone (01256) 310200  
 Fax (01256) 310201  
 www.scottwilson.com

Drawing Number <b>P/D111870/H/100/1023</b>	Rev <b>C</b>
---	-----------------