

PIER 2  
 WEST ELEVATION  
 (1:250)

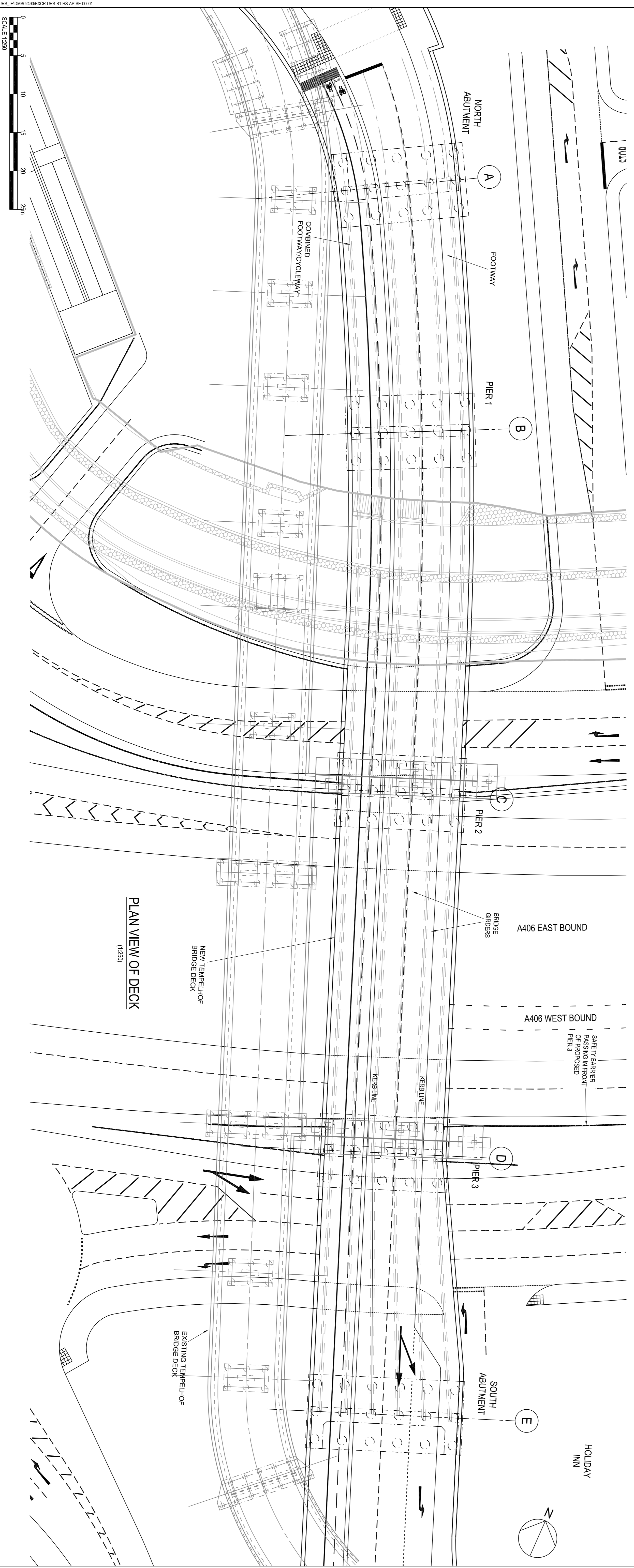

PLAN VIEW OF DECK  
 (1:250)

Highway alignment revised. Note 5 added. Part 1 moved south by 800mm. Span 1 and 2 dimensions updated to suit. Updated for planning submission. Revision Details	SM MCH 22/10/15 P10	1. THIS DRAWING IS TO BE USED IN CONJUNCTION WITH ALL OTHER RELEVANT DRAWINGS. 2. DO NOT SCALE FROM THIS DRAWING. USE ONLY PRINTED DIMENSIONS. 3. ALL DIMENSIONS IN MILLIMETERS. ALL CHANGES, LEVELS AND COORDINATES ARE IN METERS. 4. THIS DRAWING IS TO BE USED ONLY FOR THE PURPOSE OF ISSUE. 5. FINAL DIMENSIONS SHALL TO BE SUBJECT TO UNDER CONSTRUCTION.	SAFETY, HEALTH AND ENVIRONMENTAL INFORMATION BOX IT IS ASSUMED THAT ALL WORKS ON THIS DRAWING WILL BE CARRIED OUT BY A COMPETENT CONTRACTOR WORKING UNDER APPROPRIATE TO AN APPROPRIATE METHOD STATEMENT. THIS DRAWING IS TO BE USED ONLY FOR THE PURPOSE OF ISSUE THAT IT WAS ISSUED FOR AND IS SUBJECT TO AMENDMENT. Proposed at Issue <b>APPROVAL IN PRINCIPLE</b>
	SM MCH 19/10/15 P09		
	SM MCH 09/10/15 P08		
	SM MCH 09/10/15 P08		
	SM MCH 09/10/15 P08		
Scale: 1:250 0 5 10 15 20 25m	Sheet <b>Standard Life Investments</b> <b>Hammerson</b> <b>BRENT CROSS CRICKLEWOOD</b>	Project Title <b>TEMPELHOF BRIDGE GENERAL ARRANGEMENT TEMPELHOF AVENUE LEVEL</b>	Date 22/10/15
URS Infrastructure & Environment UK Limited Scot House Arden Lane Tel: +44 (0)1296 101000 Fax: +44 (0)1296 101001 <a href="http://www.urscorp.com">www.urscorp.com</a>	Drawing Number <b>BXCR-URS-B1-HS-AP-SE-00001</b>	Scale P10	