

KEY		General Purpose Meadow Mix	
	Proposed Trees/Shrubs		General Purpose Meadow Mix
	Cair Roll		Emersgate Wildflower Meadow Mix EM2 sown at a rate of 4g/m ² or similar and approved
	Pre-established 300mm diameter rolls manufactured by Salix or similar and approved. Standard Mix -	Wildflowers	%
	Carex acutiformis 20%	Achillea millefolium	0.5
	Juncus effusus 20%	Centaurea nigra	2
	Lythrum salicaria 20%	Daucus carota	0.5
	Iris pseudacorus 20%	Galium verum	1.5
	Phalaris arundinacea 20%	Knautia arvensis	2
Lower Marginal/Aquatic Mix		Leucanthemum vulgare	2
	Colour Mix - 2L @ 5/m ²	Lolus corniculatus	2
	Eleocharis palustris 25%	Plantago lanceolata	2
	Iris pseudacorus 25%	Primula veris	1.5
	Glyceria maxima 25%	Prunella vulgaris	0.4
	Juncus articulatus 25%	Ranunculus acris	3
	Grassy Mix - 2L @ 5/m ²	Rhinanthus minor	1.5
	Butomus umbellatus 40%	Rumex acetosa	1
	Carex riparia 40%	Trifolium pratense	0.1
	Phragmites australis 20%		20%
Upper Marginal		Grasses	
	Screening Mix - 2L @ 5/m ²	Agrostis capillaris	8
	Angelica sylvestris 20%	Cynosurus cristatus	40
	Carex pendula 20%	Festuca rubra	28
	Epilobium hirsutum 20%	Phleum bertolonii	4
	Glyceria declinata 20%		80%
	Juncus articulatus 20%	Woodland Mixture	
	Shade Mix - 2L @ 5/m ²	Emersgate mixture of woodland EW1 sown at a rate of 4g/m ² or similar and approved.	
	Asplenium scolopendrium 20%	Wildflowers	%
	Carex pendula 20%	Alliaria petiolata	3
	Dryopteris filix-mas 20%	Allium ursinum	0.8
	Dryopteris dilatata 20%	Betonica officinalis	1.5
	Helleborus foetidus 15%	Campanula trachelium	0.5
	Osmunda regalis 5%	Digitalis purpurea	1.6
	General Mix (Pink Colour Mix) 2L @ 5/m ²	Filipendula ulmaria	2.5
	Cardamine pratensis 15%	Geum urbanum	3
	Glyceria declinata 15%	Hyacinthoides non-scripta	2
	Juncus articulatus 15%	Primula vulgaris	0.1
	Lychnis flos cuculi 20%	Silene dioica	2.5
	Lythrum salicaria 20%	Silene flos-cuculi - (Lychnis flos-cuculi)	0.5
	Veronica catenata 15%	Stachys sylvatica	1
	General Mix (White Colour Mix) 2L @ 5/m ²	Teucrium scorodonia	1
	Angelica sylvestris 20%		20%
	Cardamine pratensis 20%	Grasses	
	Carex pendula 10%	Agrostis capillaris	10
	Filipendula ulmaria 20%	Anthoxanthum odoratum	3
	Glyceria declinata 10%	Brachypodium sylvaticum	6
	Juncus articulatus 10%	Cynosurus cristatus	30
	Veronica catenata 10%	Deschampsia cespitosa	2
	Terrestrial Mix 1L @ 8/m ² in groups of 15 by species	Festuca rubra Slender	20
	Bidens cernua 15%	Poa nemoralis	10
	Cardamine pratensis 15%		80%
	Deschampsia cespitosa 20%	Amenity Grass Mix	
	Filipendula ulmaria 10%	British Seed Houses 'A19' grass seed mix, sown at a rate of 25g/m ² or similar and approved.	
	Lotus pendunculatus 10%	Corail	30%
	Lychnis flos cuculi 20%	Raisa	25%
	Lysimachia vulgaris 10%	Escapade	20%
	Path Mix - Plugs @ 25/m ²	Vesuvius	20%
	Arrhenatherum elatius 25%	Highland	5%
	Cardamine pratensis 15%	Live Willow Stakes	
	Carex pendula 10%	Stakes @2m ² manufactured by Salix or similar and approved.	
	Deschampsia cespitosa 25%	Salix caprea	50%
	Lychnis flos-cuculi 25%	Salix cinerea	50%
	Climbers Mix 1 - 10L @ 2/linear m	Native woodland Hedge	
	Humulus lupulus 50%	Planted in double staggered row @ 500mm centers	
	Parthenocissus quinquefolia 50%	Carpinus betulus	15%
	Climbers Mix 2 - 10L @ 2/linear m	Corylus avellana	10%
	Lonicera periclymenum 40%	Crataegus monogyna	30%
	Rosa arvensis 30%	Ilex aquifolium	15%
	Hedera helix 30%	Ligustrum vulgare	15%
	Climbers Mix 3 - 10L @ 2/linear m	Viburnum opulus	15%
	Clematis vitalba 50%	North Bank General Purpose Meadow Mix	
	Hedera helix 50%	plant mix as general purpose meadow mix above.	
		North Bank Live Cair Rolls	
		stacked rolls plant mix as cair rolls above	
		North Bank Live Willow Stakes	
		plant mix as live willow stakes above	
		North Bank Inert hazel Fascine	
		0.4m diameter manufactured by Salix or similar and approved.	

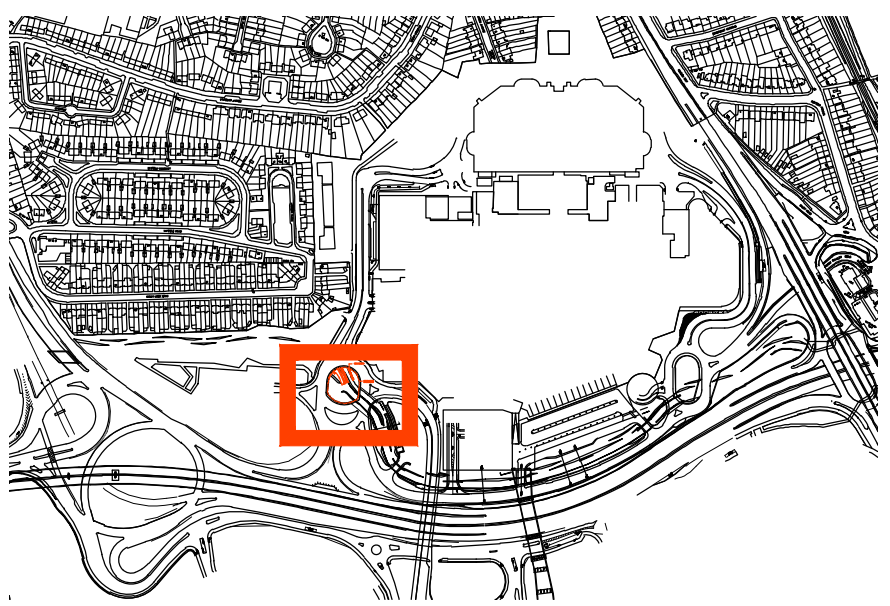

Extent of Brent River Park Phase 1AN

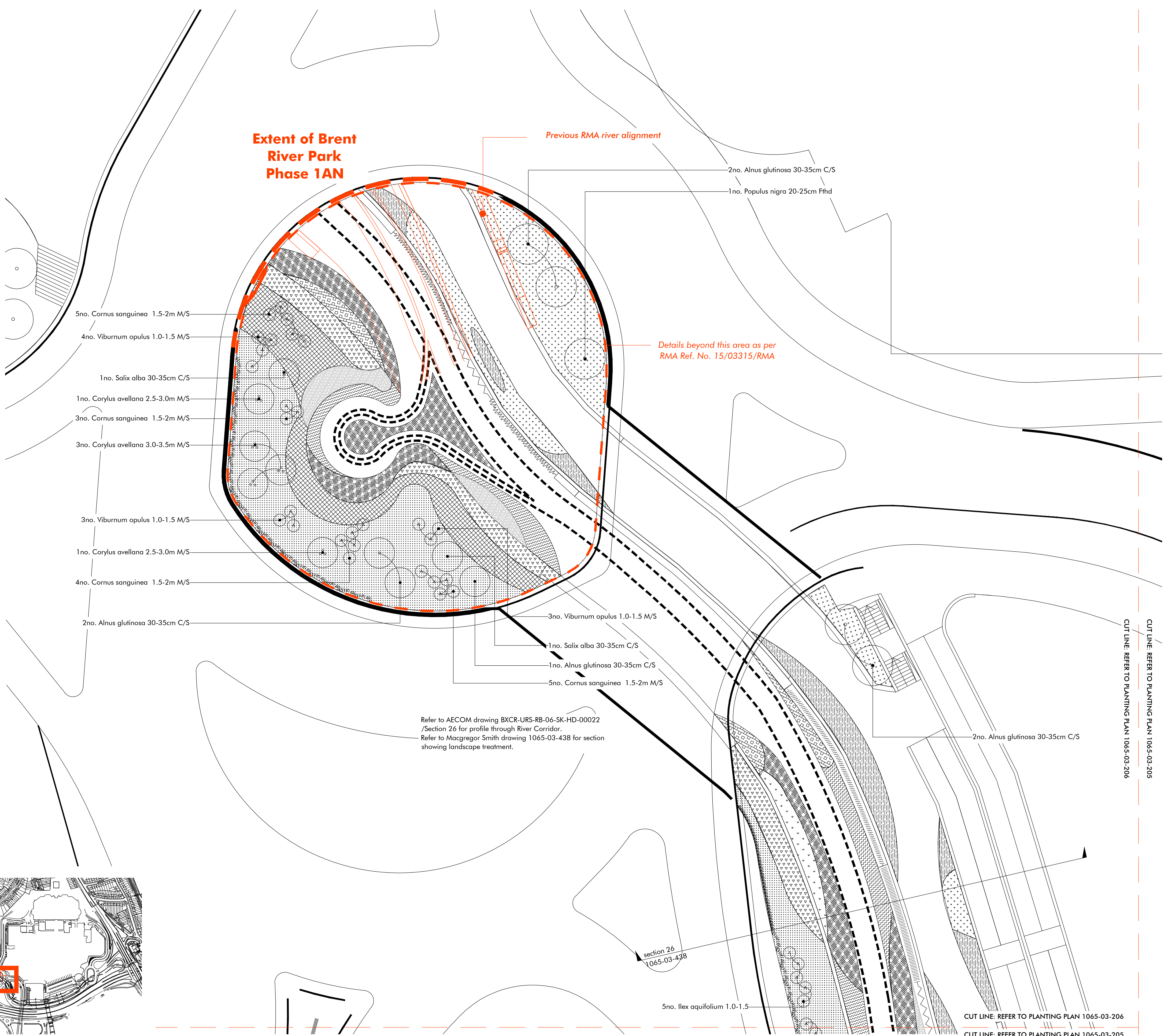

- 5no. Cornus sanguinea 1.5-2m M/S
- 4no. Viburnum opulus 1.0-1.5 M/S
- 1no. Salix alba 30-35cm C/S
- 1no. Corylus avellana 2.5-3.0m M/S
- 3no. Cornus sanguinea 1.5-2m M/S
- 3no. Corylus avellana 3.0-3.5m M/S
- 3no. Viburnum opulus 1.0-1.5 M/S
- 1no. Corylus avellana 2.5-3.0m M/S
- 4no. Cornus sanguinea 1.5-2m M/S
- 2no. Alnus glutinosa 30-35cm C/S
- 3no. Viburnum opulus 1.0-1.5 M/S
- 1no. Salix alba 30-35cm C/S
- 1no. Alnus glutinosa 30-35cm C/S
- 5no. Cornus sanguinea 1.5-2m M/S
- 2no. Alnus glutinosa 30-35cm C/S
- 5no. Ilex aquifolium 1.0-1.5

Refer to AECOM drawing BXC-URS-RB-06-SK-HD-00022 /Section 26 for profile through River Corridor. Refer to Macgregor Smith drawing 1065-03-438 for section showing landscape treatment.

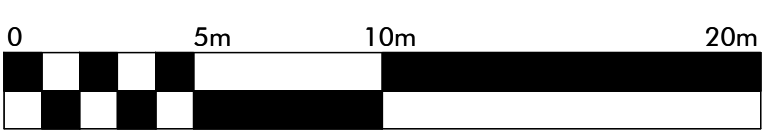

CUT LINE: REFER TO PLANTING PLAN 1065-03-205
CUT LINE: REFER TO PLANTING PLAN 1065-03-205

Revision	Description	Drawn by	Checked by	Date	Revision	Description	Drawn by	Checked by	Date
-	1st Issue	JR	IG	07.11.14	M	Phase 1AN RMA Submission	JR	GG	28.10.15
A	Phase 1AN RMA Submission	JR	IG	14.11.14					
B	Phase 1AN RMA Submission	RH	JR	28.11.14					
C	Updated River Corridor	JR	GG	18.05.15					
D	Phase 1AN RMA Submission	JR	GG	26.05.15					
E	Phase 1AN RMA Submission	JR	GG	06.08.15					
F	Phase 1AN RMA Submission	GG	GG	26.08.15					
G	Phase 1AN RMA Submission	JR	GG	21.10.15					
H	Phase 1AN RMA Submission	JR	GG	22.10.15					
I	Phase 1AN RMA Submission	JR	GG	23.10.15					
J	Phase 1AN RMA Submission	JR	GG	23.10.15					
K	Phase 1AN RMA Submission	JR	GG	28.10.15					
L	Phase 1AN RMA Submission	JR	GG	28.10.15					

NOTE
A To be read in conjunction with Macgregor Smith Base, Soft and Hardworks Specifications
B For sections refer to drawings 1065-03-433 to 1065-03-438

Xrefs
ARCH - CT - SK-937-rev_01_Masterplan 3C Outline
ENG - AECOM - BXC-URS-RB-06-M2-HD-00001
ENG - AECOM - BXC-URS-RB-06-M2-HD-00002
ENG - AECOM - BXC-URS-RB-06-M2-HD-00003_P03
ENG - AECOM - BXC-URS-ZZ-HW-M2-CE-00002_P26.3
ENG - AECOM - BXC-URS-ZZ-HW-M2-CE-00004

Macgregor • Smith Landscape Architecture			
project	Brent Cross Cricklewood	drawn by	JR
status	Phase 1AN RMA Submission	checked by	IG
title	Brent River Park Reach 2 Planting Plan - 06/09	date	28.10.15
		scale	1/200@A1
drawing No	1065-03-206	revision	M

This drawing is protected by copyright. Contractors must check all dimensions on site. Only figure dimensions are to be worked from. Discrepancies must be reported to architect before proceeding. Christopher House, 11-12 High Street, Bath, BA1 5AQ Tel:01225 464 490 e-mail: enquiries@macgregorsmith.co.uk