

**Section 1:20@A3**

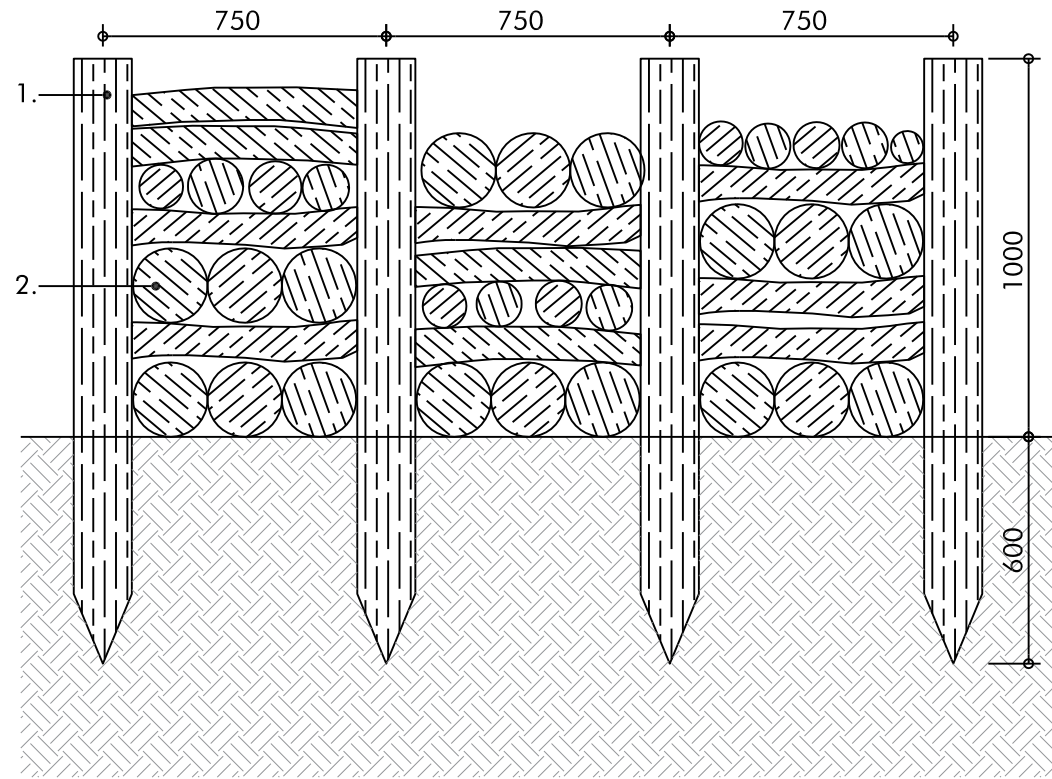

**Key**

1. Hardwood Stakes driven min 600mm depth @ 750mm centres into ground to form vertical supports.
2. Place logs from tree works on site, min 250mm diameter. Stakes in alternative traverse layers.

**Notes**

- A. All details to be read in conjunction with the General Arrangement Plans, Biodiversity Strategy and Specifications.
- B. Please see notes attached at Drawing Notes Q1.

**Location Plan  
Not to scale**

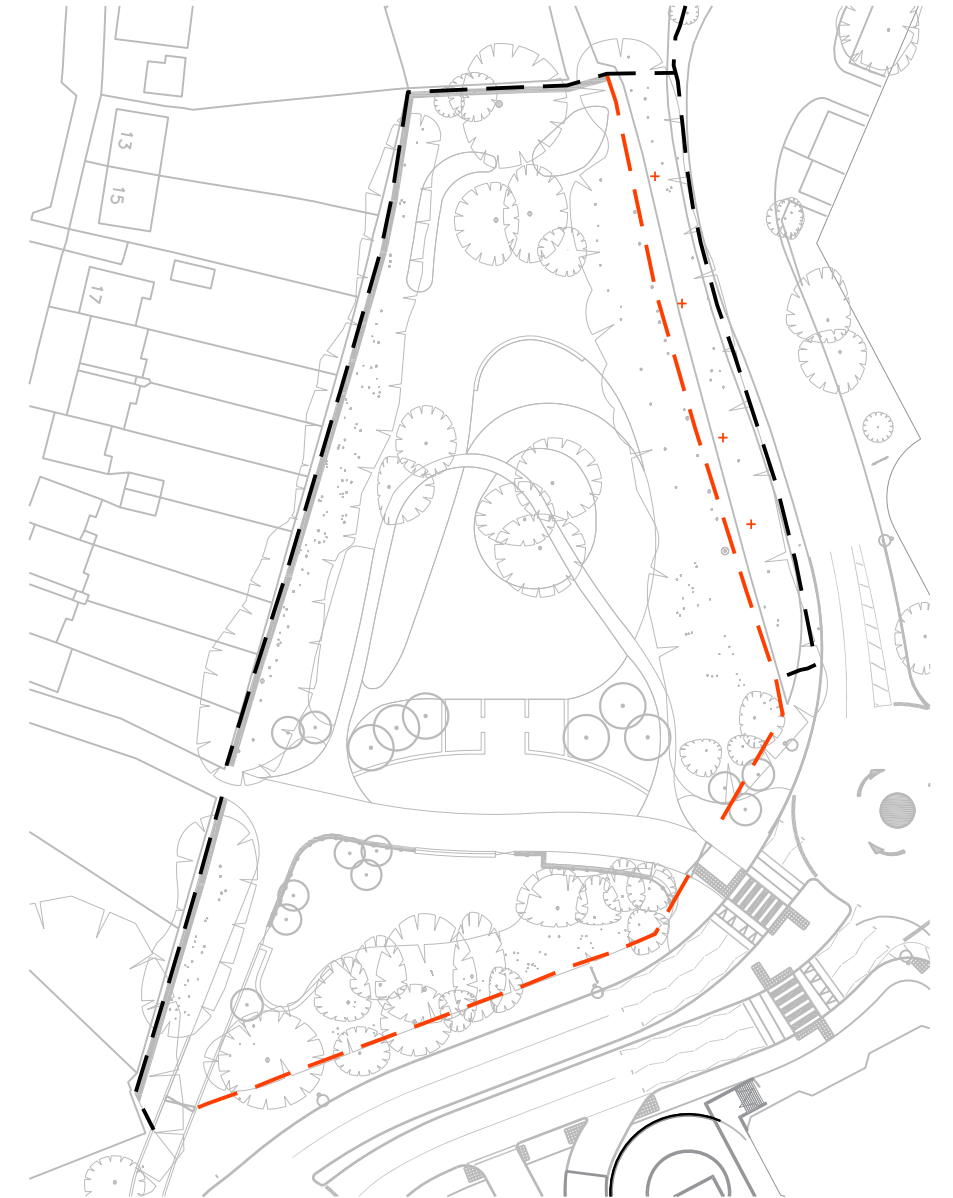

**Key**

- Existing boundary iron railing fence (IRF) retained
- Existing boundary close board fence (CBF) retained
- + Proposed log piles

Revision	Description	Drawn by	Checked by	Date
-	Draft Phase 1BN RMA Submission	IM	GG	03.03.17
A	Phase 1BN RMA Submission	IM	GG	29.03.17

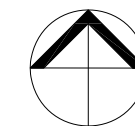

**Macgregor ▪ Smith**  
Landscape Architecture



project	Brent Cross Cricklewood 1BN Sturgess Park	drawn by	IM
status	Phase 1BN RMA Submission	checked by	GG
title	Typical Small Log Pile Detail	date	03.03.17
Xref	-	scale	1:20@A3
drawing No	1065-14-416	revision	<b>A</b>